

SC FIBER OPTIC ADAPTERS

Description

' SC* adapter has a plastic housing and either a precision zirconia or a rugged phosphor bronze sleeve. Zirconia sleeve enables stable connection and thus enhances performance, and is ideal for single mode applications. Phosphor bronze sleeve provides durability, and is ideal for multimode applications. Flange-mount type simplex and duplex adapters are available.

SC simplex



SC duplex



Features

- Low insertion loss
- Good exchangeability and repeatability
- Zirconia or phosphor-bronze sleeve
- Simplex or duplex
- Flange mount style

Applications

- Telecommunication
- Computer networks
- CATV networks
- Active device termination
- Instrumentation

Specifications

Characteristics	Unit	Single Mode	Multimode
Insertion Loss (IL)	dB	≤0.2	
Exchangeability	dB	ΔIL≤0.2	
Repeatability (500 remates)	dB	ΔIL≤0.2	
Sleeve material	-	Zirconia	
Housing material	-	Plastic	
Operating Temperature	°C	-20 ~ +70	
Storage Temperature	°C	-40 ~ +70	

Dimensional Drawing

Simplex

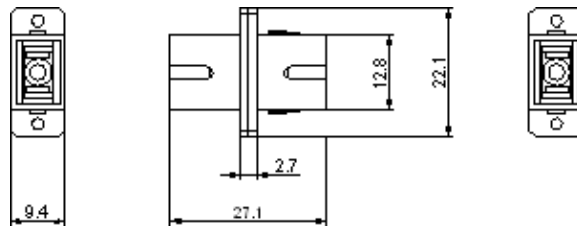

Dimensional Drawing

Duplex

